

FOR LEASE

BRISBANE BAYSIDE REAL ESTATE

# THE WHITE HOUSE

312 Colburn Avenue, Victoria Point

All Enquiries to Reg Kaasik 0413 120 333



\$130 p.w + outgoings



6 offices available



## THE PROPERTY

The Whitehouse is available to lease a range of commercial office spaces, targeted to technology and innovation companies. Located closely to major shopping centres, public transport and junior schools, this location is ideal for you and your bussiness.



## KEY FACTS

- ✓ 8-19 Square Meter Offices
- ✓ Onsite Parking
- ✓ Outdoors Area
- ✓ Storage Spaces Available
- ✓ Shared Kitchen Facilities
- ✓ Shower and Toilet Onsite
- ✓ Ideal Location
- ✓ Food Outlet + Drink Outlet

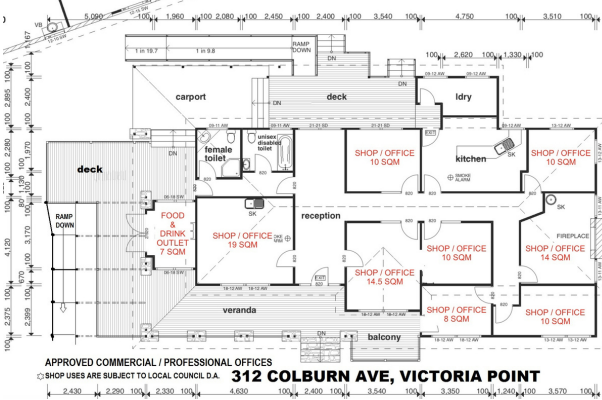

**ENQUIRE NOW!**

**BE PART OF THE REDLAND TECHNOLOGY & INNOVATION SCENE**

This property has a number of shared spaces, including a kitchen, shower and toilets, outdoor patio and various outdoor seating areas!

**SCHEDULE A PRIVATE VIEWING TODAY!**

Reg Kaasik, Real Estate Agent  
 0413 120 333  
 reg@bbre.com.au

